

26. Bài 26

Questions 11 and 12

Label the map below. Write **NO MORE THAN TWO WORDS** for each answer.



Question 13 to 18

Complete the table below. Write **NO MORE THAN THREE WORDS** and or numbers for each answer.

	Attraction	Further information
Stop A: Main Booking Office First boat: 8 a.m. Last boat: 13.....p m	Palace	has lovely 14.....
Stop B	15.....	Have good 16..... off City Centre
Stop C	museum	book shop specialising in the 17..... of local area
Stop D	entertainment complex	18..... cinema - bowling alley - video games arcade

Question 19 and 20

Write **NO MORE THAN THREE WORDS AND OR NUMBERS** for each answer.

19. How often do the top bus **company** tour run?

.....

20. Where can you catch in number one sightseeing to **form**?

.....

27. Bài 27

Questions 11 - 16

Choose the correct letter A, B, or C.

Sponsored Walking Holiday

11. On the holiday, you will be walking for

- A. 6 days.
- B. 8 days.
- C. 10 days.

12. What **proportion** of the sponsorship money goes to charity?

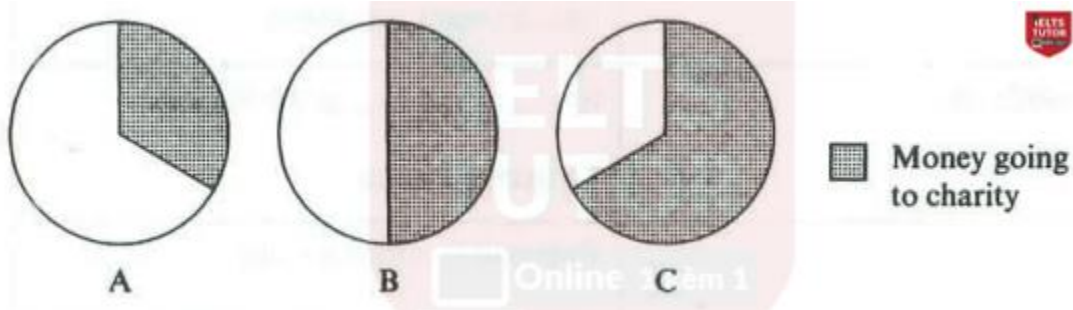

13. Each walker's sponsorship money goes to one

- A. student.
- B. teacher.
- C. school.

14. When you start the trek you must be

- A. interested in getting fit.
- B. already quite fit.
- C. already very fit.

15. As you walk you will carry

- A. all of your belongings
- B. some of your belongings
- C. **none** of your belongings

16. The Semira Region has a long tradition of

- A. making carpets
- B. weaving blankets
- C. carving wood.

Questions 17 - 20

Complete the form below. Write ONE WORD ONLY for each answer.

ITINERARY	
Day 1	Arrive in Kishba
Day 2	Rest day
Day 3	Spend all day in a (17).....
Day 4	Visit a school
Day 5	Rest day
Day 6	See a (18).....with old carvings
Day 7	Rest day
Day 8	Swim in a (19).....
Day 9	Visit a (20).....
Day 10	Depart from Kishba



28. Bài 28

Questions 11-14.

Choose the correct letter, A, B or C.

11. What kind of tour is Sally leading?

- A. a bus tour
- B. a train tour
- C. a walking tour

12. The **original** buildings on the site were

- A. houses.
- B. industrial buildings.
- C. shops.

13. The local residents wanted to use the site for

- A. leisure.
- B. apartment blocks.
- C. a sports centre.

14. The Tower is at the centre of the

- A. nature reserve.
- B. formal gardens.
- C. Bicentennial **Park**.

Questions 15-17

Label the plan below. Write **NO MORE THAN TWO WORDS** for each answer.

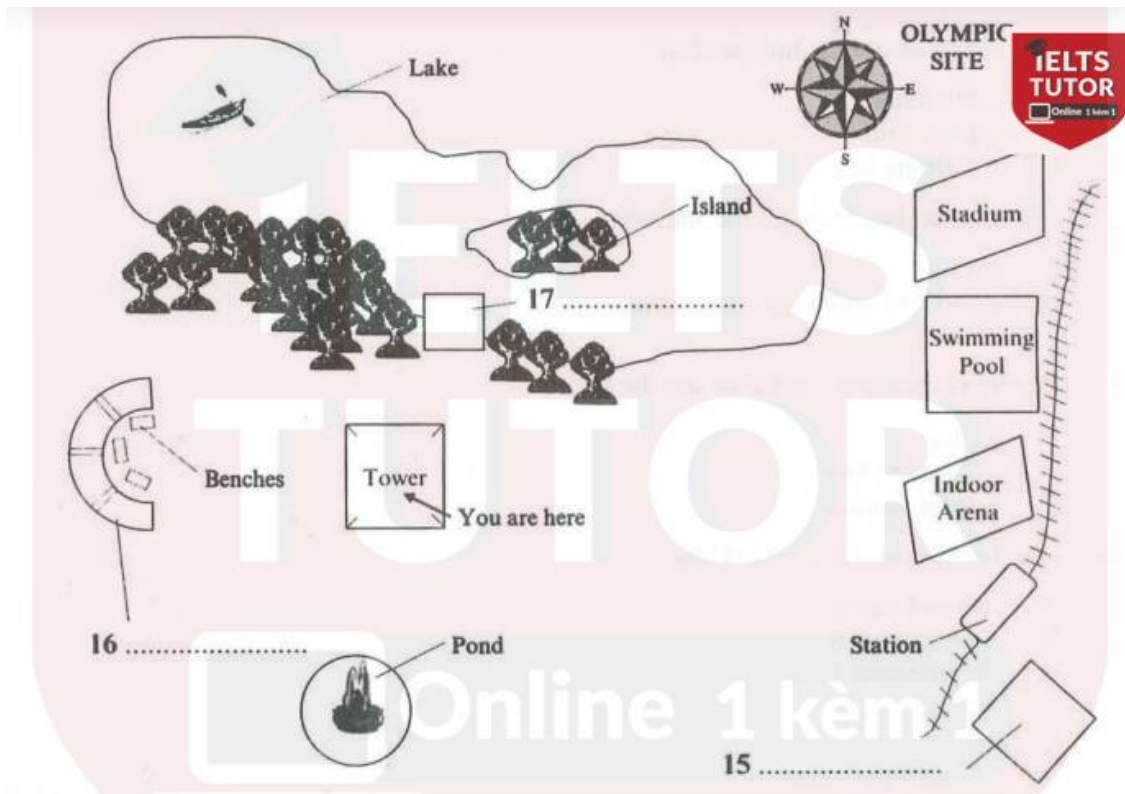

Questions 18-20

Complete the table below. Write **NO MORE THAN TWO WORDS** for each answer.

Nature Reserve

Area	Facility	Activity
The Mangroves	boardwalk	18
Frog Pond	outdoor classroom	19
The Waterbird Refuge	20	bird watching

29. Bài 29

Questions 11 – 15: Complete the sentences below. Write **NO MORE THAN TWO WORDS AND / OR A NUMBER** for each answer.

THE DINOSAUR MUSEUM

11. The museum **closes** at _____ p.m. on Mondays.
12. The museum is not open on _____.
13. School groups are met by tour guides in the _____.
14. The whole visit takes 90 minutes, including _____ minutes for the guided tour.
15. There are _____ behind the museum where students can have lunch.

Questions 16 – 18: Choose **THREE** letters, A – G.

Which **THREE** things can students have with them in the museum?

- A food
- B water
- C cameras
- D books
- E bags
- F pens
- G worksheets

Questions 19 and 20: Choose **TWO** letters, A – E.

Which **TWO** activities can students do after the tour at present?

- A build model dinosaurs
- B watch films
- C draw dinosaurs
- D find dinosaur eggs
- E **play** computer games

30. Bài 30

Question 11

Choose the correct letter, A, B or C.

11. According to the speaker, the main purposes of the park are

- A. education and entertainment.
- B. research and education.
- C. research and entertainment.

Questions 12-14

Label the plan below. Write **NO MORE THAN TWO WORDS** for each answer.

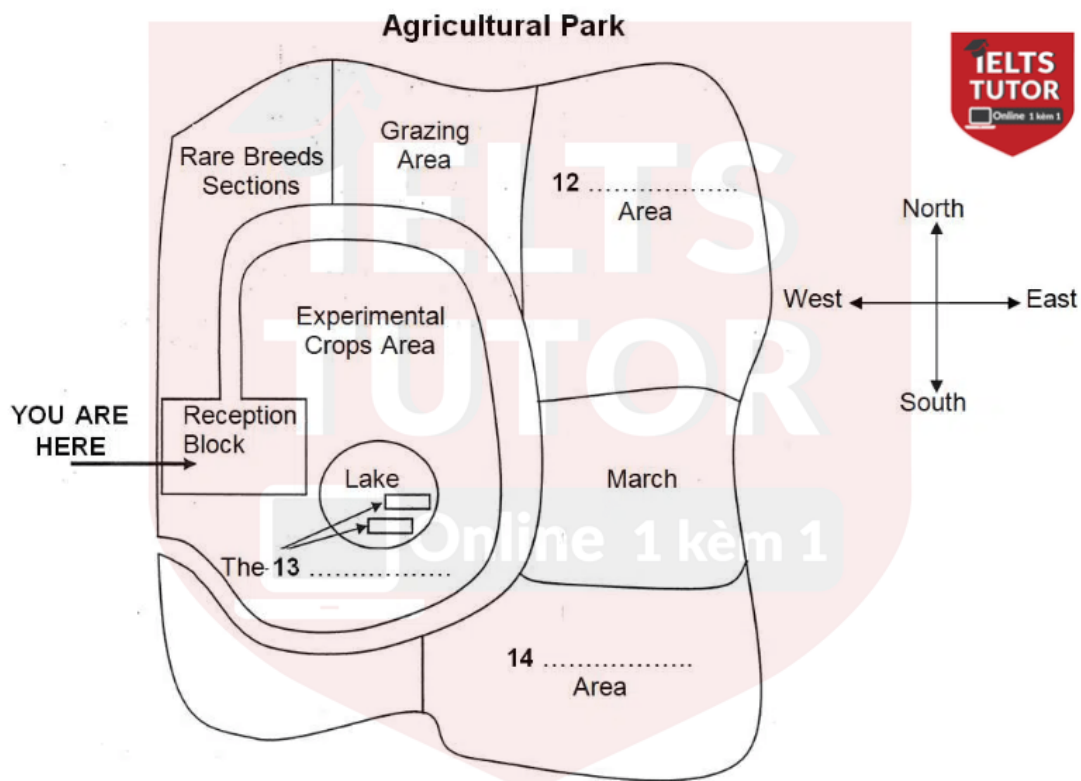

Questions 15-20

Choose the correct letter, A, B or C.

15. When are the experimental areas closed to the public?
- A. all the year round
 - B. almost all the year
 - C. a short time every year
16. How can you move around the park?
- A. by tram, walking or bicycle
 - B. by solar car or bicycle
 - C. by bicycle, walking or bus
17. The rare bread animals kept in the park include
- A. hens and horses
 - B. goats and cows
 - C. goats and hens
18. What is the main purpose of having the Rare Breeds Sections?
- A. to save unusual animals
 - B. to keep a variety of breeds
 - C. to educate the public
19. What can you see in the park at the present time?
- A. the arrival of wild birds
 - B. fruit tree blossom
 - C. a demonstration of fishing
20. The shop contains books about
- A. animals
 - B. local traditions
 - C. the history of the park.

31. Bài 31

Questions 11-16

Complete the notes below. Write **NO MORE THAN TWO WORDS AND/OR A NUMBER** for each answer.

THE NATIONAL ARTS CENTRE

Well known for: 11.....

Complex consists of:

- concert rooms
- theatres
- cinemas
- art galleries
- public library
- restaurants
- a 12

Historical background:

- 1940 – area destroyed by bombs
- 1960s-1970s - Centre was 13..... and built
- in 14..... – opened to public

Managed by: the 15.....

Open: 16..... days **per** year

Questions 17-20

Complete the table below. Write NO MORE THAN THREE WORDS AND/OR A NUMBER for each answer.

Day	Time	Event	Venue	Ticket price
Monday and Tuesday	7.30 p.m	'The Magic Flute' (opera by Mozart)	17.....	From £8.00
Wednesday	8.00 p.m	18..... (Canadian film)	Cinema 2	19..... £
Saturday and Sunday	11 a.m. to 10 p.m	20..... (art exhibition)	Gallery 1	free

32. Bài 32

Questions 11-13

Choose the correct letter, A, B or C.

Improvements to Red Hill Suburb

11. Community groups are mainly concerned about
- A. pedestrian safety.
 - B. traffic jams.
 - C. increased pollution.
12. It has been decided that the overhead power lines will be
- A. extended
 - B. buried
 - C. repaired
13. The expenses related to the power lines will be paid for by
- A. the council.
 - B. the power company.
 - C. local businesses.

Questions 14-20

Label the map below. Write the correct letter, A-H, next to questions 14-20.

Red Hill Improvement Plan

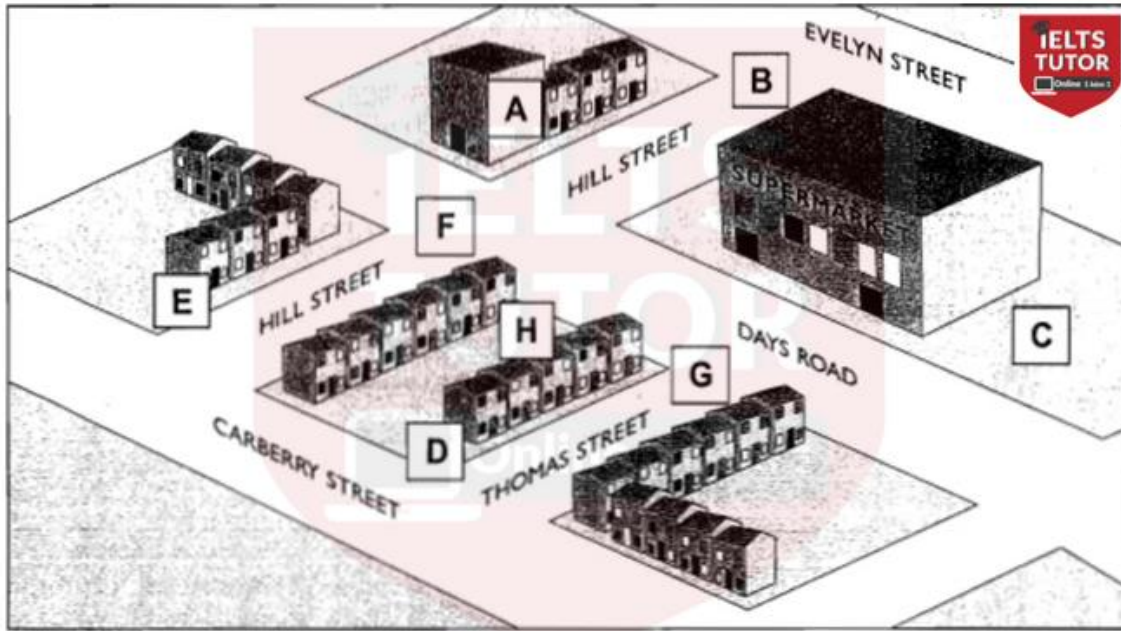

- 14. tree.....
- 15. wider footpaths.....
- 16. coloured road surface.....
- 17. new sign.....
- 18. traffic lights.....
- 19. artwork.....
- 20. children's playground.....

33. Bài 33

Questions 11-16: Complete the notes below. Write ONE WORD AND/OR A NUMBER for each answer.

SPORTS WORLD

a new 11 of an international sports goods company located in the shopping center to the 12 of Bradcaster has sports 13 and equipment on floors 1 – 3 can get you any item within 14 days shop specializes in equipment for 15 has a special section which just sells 16

Questions 17 and 18: Choose the correct letter A, B or C.

17. A champion athlete will be in the shop

- A. on Saturday morning only.
- B. all day Saturday.
- C. for the whole weekend.

18. The first person to answer 20 quiz questions correctly will win

- A. gym membership.
- B. a video.
- C. a calendar.

Questions 19 and 20: Choose TWO letters, A-E.

Which TWO pieces of information does the speaker give about the fitness test?

- A. You need to reserve a place.
- B. It is free to account holders.
- C. You get advice on how to improve your health.
- D. It takes place in a special clinic.
- E. It is cheaper this month.

34. Bài 34

Question 11 - 13

Complete the table below. Write **NO MORE THAN THREE WORDS**.

PARKS AND OPEN SPACES

Name of place	Of particular interest	Open
Holland Common	source of River Ouse	24 hours
Holt Island	many different 11	between 12 and
Longfield Country Park	reconstruction of a 2,000-year-old 13with activities for children	daylight hours

Questions 14-16: Choose the correct letter A, B or C.

Long field Park

14. As part of Mondays activity, visitors will

- A. prepare food with herbs.
- B. meet a well-known herbalist
- C. dye cloth with herbs.

15. For the **activity** on Wednesday.

- A. only group bookings are accepted.
- B. visitors should book in advance.
- C. attendance is free.

16. For the activity on Saturday, visitors should

- A. come in suitable clothing.
- B. make sure they are able to stay for the whole day.
- C. tell the rangers before the event what they wish to do.

Questions 17-20

Label the map below. Write the correct letter A-L, next to questions 17-20.

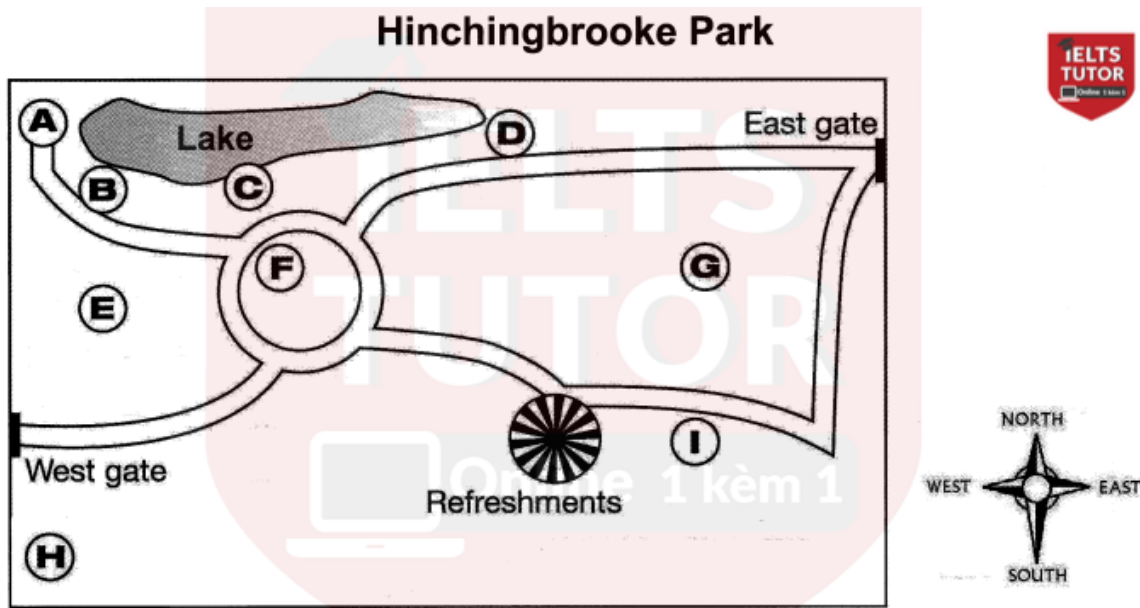

- 17. bird hide
- 18. dog walking area.....
- 19. flower garden
- 20. wooded area.....

35. Bài 35

Question 11 – 13

Choose the correct letter A, B or C.

Winridge Forest Railway Park

11. Simon's idea for a theme park came from
- A. his childhood hobby.
 - B. his interest in landscape design.
 - C. his visit to another park.
12. When they started, the family decided to open the park only when
- A. the weather was expected to be good.
 - B. the children weren't at school.
 - C. there were fewer farming commitments.
13. Since opening, the park has had
- A. 50.000 visitors.
 - B. 1.000.000 visitors.
 - C. 1,500.000 visitors.

Questions 14-18

What is currently the main area of work of each of the following people?

Choose FIVE answers from the box and write the correct letter A-H, next to questions 14-18.

Area of work

- A. advertising
- B. animal care
- C. building
- D. educational links
- E. engine maintenance

F. food and drink

G. sales

H. staffing

People

14. Simon (the speaker)

15. Liz

16. Sarah

17. Duncan

18. Judith,.....

Questions 19 and 20

Complete the table below. Write ONE WORD AND/OR NUMBERS for each answer.

Feature	Size	Biggest challenge	Target age group
Railway	1.2 km	Making tunnels	
Go-Kart arena	19 m ²	Removing mounds on the track	20 year-olds



36. Bài 36

Questions 11-13

Label the diagram below. Choose **THREE** answers from the box and write the correct letter A-E, next to questions 11-13.

- A electricity indicator
- B on/off switch
- C reset button
- D time control
- E warning indicator

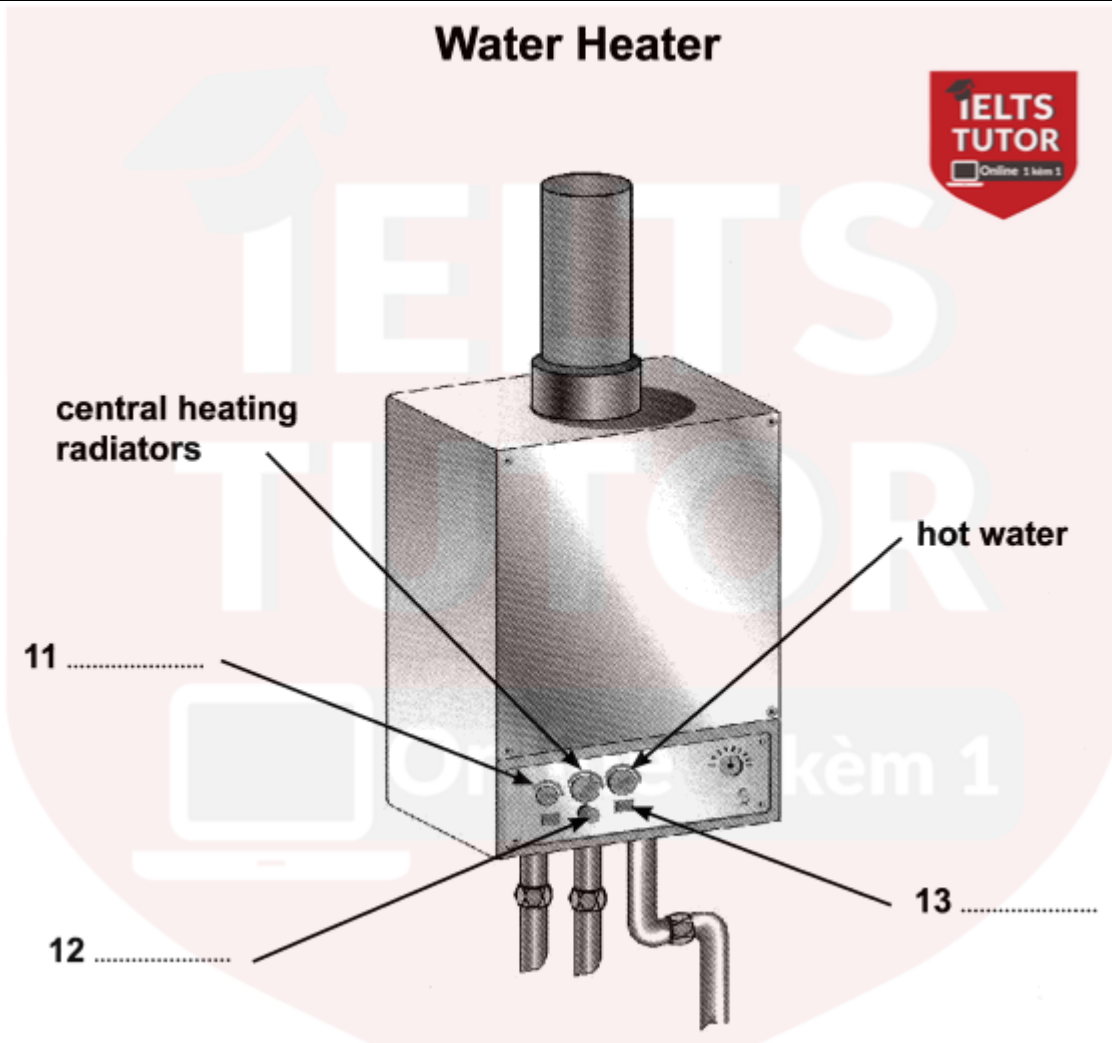

Questions 14-18

Where can each of the following items be found?

Choose *FIVE* answers from the box and write the correct letter: A-G, next to questions 14-18.

Locations

- A. in box on washing machine
- B. in cupboard on landing
- C. in chest of drawers
- D. next to window in living room
- E. on shelf by back door
- F. on top of television
- G. under kitchen sink

- 14. pillows
- 15. washing powder
- 16. key
- 17. light bulbs
- 18. map

Questions 19 and 20

Complete the notes below. Write *ONE WORD AND/OR A NUMBER* for each answer.

- The best place to park in town - next to the station
- Phone number for **takeaway** pizzas - 19
- Railway museum closed on 20



37. Bài 37

Questions 11 and 12

Choose TWO letters A-E.

Which TWO facilities at the leisure club have recently been improved?

- A. the gym
- B. the tracks
- C. the indoor pool
- D. the outdoor pool
- E. the sports training for children

Questions 13-20

Complete the notes below. Write NO MORE THAN TWO WORDS for each answer.

Joining the leisure club

Personal Assessment

- New members should describe any 13.....
- The 14..... will be explained to you before you use the equipment.
- You will be given a six-week 15.....

Types of membership

- There is a compulsory £90 16..... fee for members.
- Gold members are given 17..... to all the LP clubs.
- Premier members are given priority during 18..... hours.
- Premier members can bring some 19..... every month.
- Members should always take their 20..... with them.

38. Bài 38

Questions 11 – 14

Choose the correct letter, A, B or C.

New city developments

11. The idea for the two new developments in the city came from

- A. local people.
- B. the City Council.
- C. the SWRDC.

12. What is unusual about Brackenside pool?

- A. its architectural style
- B. its heating system
- C. its method of water treatment

13. Local newspapers have raised worries about

- A. the late opening date.
- B. the cost of the project.
- C. the size of the facilities.

14. What decision has not yet been made about the pool?

- A. whose statue will be at the door
- B. the exact opening times
- C. who will open it

Questions 15-20

Choose *SIX* answers from the box and write the correct letter, A-I, next to questions 15-20.

Which feature is related to each of the following areas of the world represented in the playground?

Features

- A. ancient forts
- B. waterways
- C. ice and snow
- D. jewels
- E. local animals
- F. mountains
- G. music and film
- H. space travel
- I. volcanoes

Areas of the world

- 15. Asia
- 16. Antarctica
- 17. South America
- 18. North America
- 19. Europe
- 20. Africa

39. Bài 39

Questions 11 and 12

Choose TWO letters, A-E.

Which TWO things does Alice say about the Dolphin Conservation Trust?

- A. Children **make up** most of the membership
- B. It's the country's largest conservation organization
- C. It helps finance campaigns for changes in fishing practices
- D. It employs several dolphin experts full-time
- E. Volunteers help in various ways

Questions 13-15

Choose the correct letter, A, B, or C.

13. Why is Alice so pleased the Trust has won the Charity Commission award?

- A. It has brought in extra money
- B. It made the work of the trust better known
- C. It has attracted more members

14. Alice says oil exploration causes problems to dolphins because of

- A. noise
- B. oil leaks
- C. movement of ships

15. Alice became interested in dolphins when

- A. she saw one swimming near her home
- B. she heard a speaker at her school
- C. she read a book about them

Questions 16-20

Write the correct letter, A, B, C or D, next to questions 16-20.

Which dolphin does Alice make each of the following comments about?

Dolphins

- A. Moon dancer
- B. Echo
- C. Kiwi
- D. Samson

Comments

- 16. It has not been seen this year
- 17. It is photographed **more than** the others
- 18. It is always very energetic
- 19. It is the newest one in the scheme
- 20. It has an unusual shape

40. Bài 40

Questions 11-15

Choose the correct letter, A, B or C.

MANHAM PORT

11. Why did a port originally **develop** at Manham?
- A. It was safe from enemy attack.
 - B. It was convenient for river transport.
 - C. It had a good position on the sea coast.
12. What caused Manham's sudden expansion during the Industrial Revolution?
- A. the improvement in mining techniques
 - B. the increase in demand for metals
 - C. the discovery of tin in the area
13. Why did rocks have to be sent away from Manham to be processed?
- A. shortage of fuel
 - B. poor transport systems
 - C. lack of skills among local people
14. What happened when the port declined in the twentieth century?
- A. The workers went away.
 - B. Traditional skills were lost.
 - C. Buildings were used for new purposes.
15. What did the Manham Trust hope to do?
- A. discover the location of the original port
 - B. **provide** jobs for the unemployed
 - C. rebuild the port complex

Questions 16-20

Write **NO MORE THAN TWO WORDS** for each answer. Complete the table below.

Tourist attractions in Manham		
Place	Features and activities	Advice
copper mine	Specially adapted miners' 16 _____ take visitors into the mountain	the mine is 17 _____ and enclosed — unsuitable for children and animals
village school	classrooms and a special exhibition of 18 _____	a 19 _____ is recommended
"The George" (old sailing ship)	the ship's wheel (was lost but has now been restored)	children shouldn't use the 20 _____

41. Bài 41

Question 11 – 14

Complete the notes below. Write ONE WORD for each answer.

Fiddy Working Heritage Farm

Advice about visiting the farm

Visitors should

- Take care not to **harm** any 11
- Not touch any 12
- Wear 13
- Not bring 14 into the farm, with certain exceptions

Question 15 – 20

Label the map below. Write the correct letter A-I, next to questions.

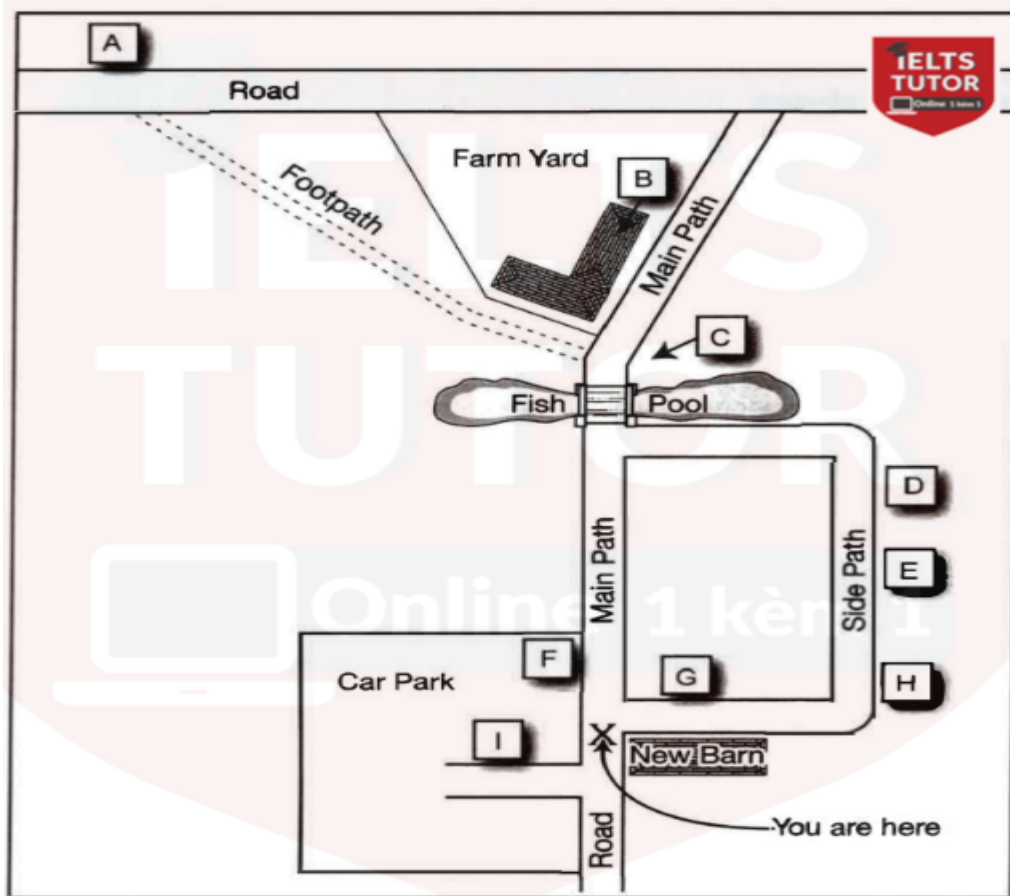

- 15. Scarecrow
- 16. Maze
- 17. Cafe
- 18. Black Barn
- 19. Covered picnic area
- 20. Fiddy House

42. Bài 42

Questions 11 – 20

New staff at theatre

Questions 11 and 12

Choose TWO letters, A-E.

Which TWO changes have been made so far during the refurbishment of the theatre?

- A. Some rooms now have a different use.
- B. A different type of seating has been installed.
- C. An elevator has been installed.
- D. The outside of the building has been repaired.
- E. Extra seats have been added.

Questions 13 and 14

Choose TWO letters, A-E.

Which TWO facilities does the theatre currently offer to the public?

- A. rooms for hire
- B. backstage tours
- C. hire of costumes
- D. a bookshop
- E. a café

Questions 15 and 16

Choose TWO letters, A-E.

Which TWO workshops does the theatre currently offer?

- A. sound
- B. acting
- C. making puppets
- D. make-up
- E. lighting

Questions 17-20

Label the plan below. Write the correct letter, A-G, next to Questions 17-20.

Ground floor plan of theatre

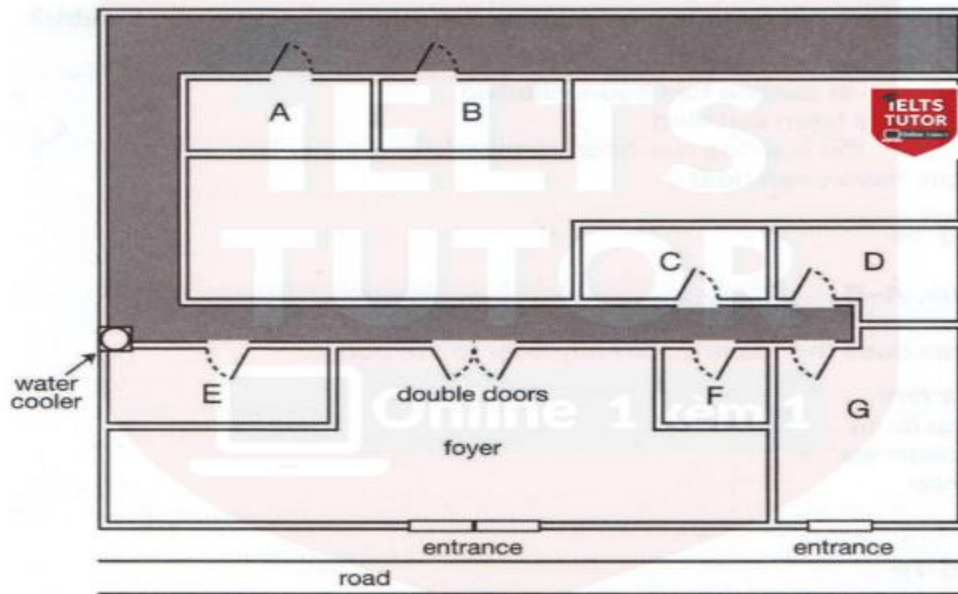

- 17. box office
- 18. theatre manager's office
- 19. lighting box
- 20. artistic director's offices

43. Bài 43

Questions 11 – 15

Choose the correct letter, A, B or C.

Changes in Barford over the last 50 years

11. In Shona's opinion, why do fewer people use buses in Barford these days?
- A. The buses are old and uncomfortable.
 - B. Fares have gone up too much.
 - C. There are not so many bus routes.
12. What change in the road network is known to have benefited the town most?
- A. the **construction** of a bypass
 - B. the development of cycle paths
 - C. the banning of cars from certain streets
13. What is the problem affecting shopping in the town centre?
- A. lack of parking spaces
 - B. lack of major retailers
 - C. lack of restaurants and cafés
14. What does Shona say about medical facilities in Barford?
- A. There is no hospital.
 - B. New medical practices are planned.
 - C. The number of dentists is too low.
15. The largest number of people are employed in
- A. manufacturing.
 - B. services.
 - C. education.

Questions 16-20

Choose *FIVE* answers from the box and write the correct letter, A-G, next to Questions 16-20

What is planned for each of the following facilities?

Plans

- A. It will move to a new location.
- B. It will have its opening hours extended.
- C. It will be refurbished.
- D. It will be used for a different purpose.
- E. It will have its opening hours reduced.
- F. It will have new management.
- G. It will be expanded.

Facilities

- 16. railway station car park
- 17. cinema
- 18. indoor market
- 19. library
- 20. nature reserve

44. Bài 44

Questions 11 – 16

Choose *SIX* answers from the box and write the correct letter, A-G, next to Questions 11-16.

What does the speaker say about each of the following collections?

Comments

- A. was given by one person
- B. was recently publicised in the media
- C. includes some items given by members of the public
- D. includes some items given by the artists
- E. includes the most popular exhibits in the museum
- F. is the largest of its kind in the country
- G. has had some of its contents relocated

Collections

- 11. 20th- and 21st-century paintings
- 12. 19th-century paintings
- 13. Sculptures
- 14. 'Around the world' exhibition
- 15. Coins
- 16. Porcelain and glass

Questions 17-20

Label the plan below. Write the correct letter, A-H, next to Questions 17-20.

Basement of museum

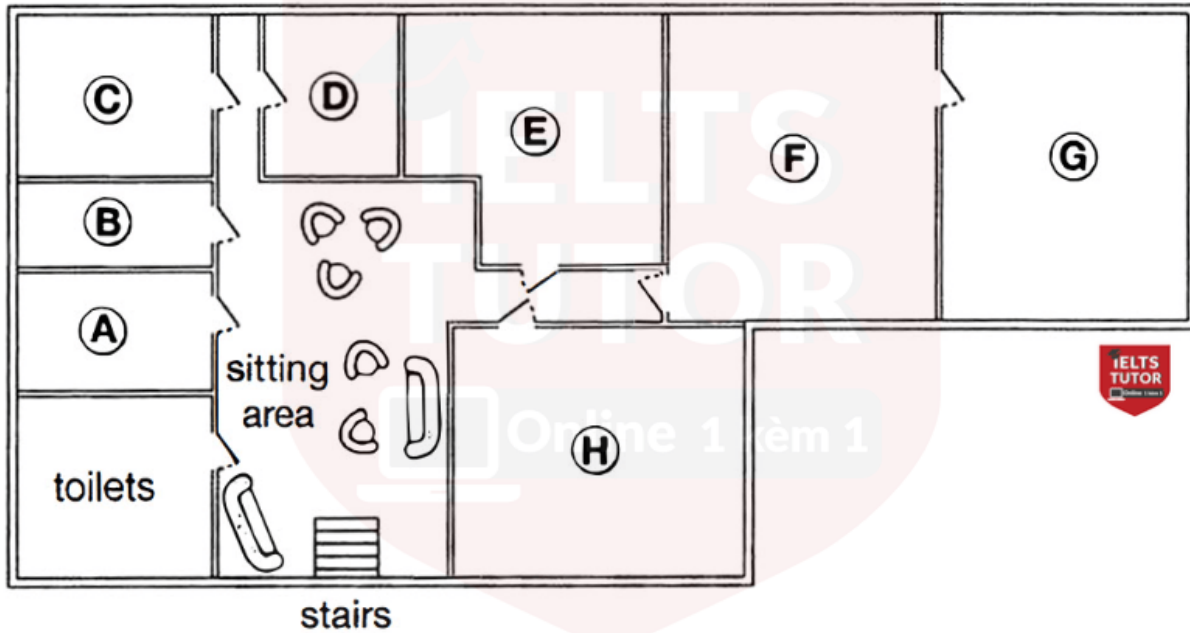

- 17. restaurant
- 18. café
- 19. baby-changing facilities
- 20. cloakroom

www.ieltstutor.vn



45. Bài 45

Questions 11-14

Choose the correct letter, A, B or C.

Talk to new kitchen assistants

11. According to the manager, what do most people like about the job of kitchen assistant?

- A. the variety of work.
- B. the friendly atmosphere.
- C. the opportunities for promotion.

12. The manager is concerned about some of the new staff's

- A. jewellery.
- B. hair styles.
- C. shoes.

13. The manager says that the day is likely to be busy for kitchen staff because

- A. it is a public holiday.
- B. the head chef is absent.
- C. the restaurant is almost fully booked.

14. Only kitchen staff who are 18 or older are allowed to use

- A. the waste disposal unit.
- B. the electric mixer.
- C. the meat slicer.

Questions 15-16

Choose *TWO* letters, A-E.

According to the manager, which *TWO* things can make the job of kitchen assistant stressful?

- A. They have to follow orders immediately.
- B. The kitchen gets very hot.
- C They may not be able to take a break.
- D. They have to do overtime.
- E. The work is physically demanding.

Questions 17-20

Choose *FOUR* answers from the box and write the correct letter, A-F, next to Questions 17-20.

What is the responsibility of each of the following restaurant staff?

Responsibilities

- A. training courses
- B. food stocks
- C. first aid
- D. breakages
- E. **staff** discounts
- F. timetables

Restaurant staff

- 17. Joy Parkins
- 18. David Field
- 19. Dexter Wills
- 20. Mike Smith

46. Bài 46

Questions 11 – 15

Choose the correct letter, A, B or C.

Theatre trip to Munich

11. When the group meet at the airport they will have
- A. breakfast.
 - B. coffee.
 - C. lunch.
12. The group will be met at Munich Airport by
- A. an employee at the National Theatre.
 - B. a theatre manager.
 - C. a tour operator.
13. How much will they pay per night for a double room at the hotel?
- A. 110 euros
 - B. 120 euros
 - C. 150 euros
14. What type of restaurant will they go to on Tuesday evening?
- A. an Italian restaurant
 - B. a Lebanese restaurant
 - C. a typical restaurant of the region
15. Who will they meet on Wednesday afternoon?
- A. an actor
 - B. a playwright
 - C. a theatre director

Questions 16-20

Choose *FIVE* answers from the box and write the correct letter, A-G, next to Questions 16-20.

What does the man say about the play on each of the following days?

Comments

- A. The playwright will be present.
- B. The play was written to celebrate an anniversary.
- C. The play will be performed inside a historic building.
- D. The play will be accompanied by live music.
- E. The play will be performed outdoors.
- F. The play will be performed for the first time.
- G. The **performance** will be attended by officials from the town.

Days

- 16. Wednesday
- 17. Thursday
- 18. Friday
- 19. Saturday
- 20. Monday

47. Bài 47

Questions 11 and 12

Choose *TWO* letters, A-E.

Which **TWO** age groups are taking increasing numbers of holidays with BC Travel?

- A. 16-30 years
- B. 31-42 years
- C. 43-54 years
- D. 55-64 years
- E. over 65 years

Questions 13 and 14

Choose *TWO* letters, A-E.

Which **TWO** are the main reasons given for the popularity of activity holidays?

- A. Clients make new friends.
- B. Clients learn a useful skill.
- C. Clients learn about a different culture.
- D. Clients are excited by the risk involved.
- E. Clients find them good value for money.

Questions 15 – 17

Choose the correct letter, A, B or C.

15. How does BC Travel plan to expand the painting holidays?

- A. by adding to the number of locations
- B. by increasing the range of levels
- C. by employing more teachers

16. Why are BC Travel's cooking holidays unusual?
- A. They only use organic foods.
 - B. They have an international focus.
 - C. They mainly involve vegetarian dishes.
17. What does the speaker say about the photography holidays?
- A. Clients receive **individual** tuition.
 - B. The tutors are also trained guides.
 - C. Advice is given on selling photographs.

Questions 18 – 20

Complete the table below. Write **ONE WORD ONLY** for each answer.

Fitness Holidays

Location	Main focus	Other comments
Ireland and Italy	general fitness	<ul style="list-style-type: none">• personally designed programme• also reduces 18
Greece	19 control	<ul style="list-style-type: none">• includes exercise on the beach
Morocco	mountain biking	<ul style="list-style-type: none">• wide variety of levels• one holiday that is specially designed for 20



48. Bài 48

Questions 11 – 14

Choose the correct letter, A, B or C.

Visiting the Sheepmarket area

11. Which is the most rapidly-growing group of residents in the Sheepmarket area?

- A. young professional people
- B. students from the university
- C. employees in the local market

12. The speaker recommends the side streets in the Sheepmarket for their

- A. international restaurants.
- B. historical buildings.
- C. arts and crafts.

13. Clothes designed by entrants for the Young Fashion competition must

- A. be modelled by the designers themselves.
- B. be inspired by aspects of contemporary culture.
- C. be made from locally produced materials.

14. Car parking is free in some car parks if you

- A. stay for less than an hour.
- B. buy something in the shops.
- C. park in the evenings or at weekends.

Questions 15 – 20

Label the map below. Write the correct letter, A-I, next to Questions 15-20.

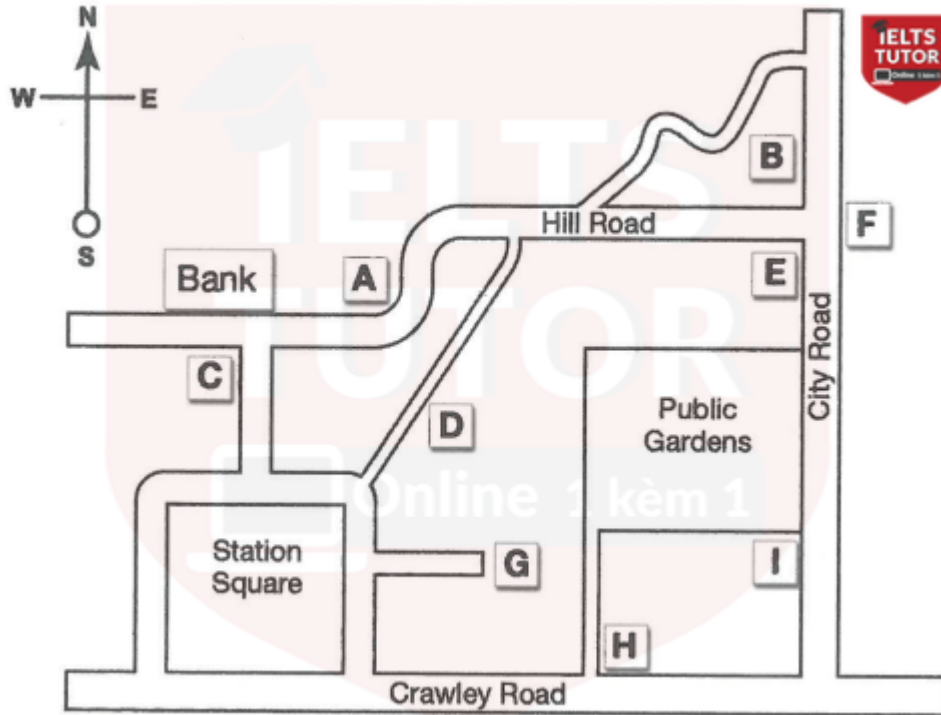

- 15. The Reynolds House
- 16. The Thumb
- 17. The Museum
- 18. The Contemporary Art Gallery
- 19. The Warner Gallery
- 20. Nucleus

49. Bài 49

Questions 11 – 13

Choose the correct letter, A, B or C.

Traffic Changes in Granford

11. Why are changes needed to traffic systems in Granford?
- A. The number of traffic accidents has risen.
 - B. The amount of traffic on the roads has increased.
 - C. The types of vehicles on the roads have changed.
12. In a survey, local residents particularly complained about
- A. dangerous driving by parents.
 - B. pollution from trucks and lorries.
 - C. inconvenience from parked cars.
13. According to the speaker, one problem with the new regulations will be
- A. raising money to pay for them.
 - B. finding a way to make people follow them.
 - C. getting the support of the police.

Questions 14-20

Label the map below. Write the correct letter, A-I, next to Questions 14-20.

Proposed traffic changes in Granford

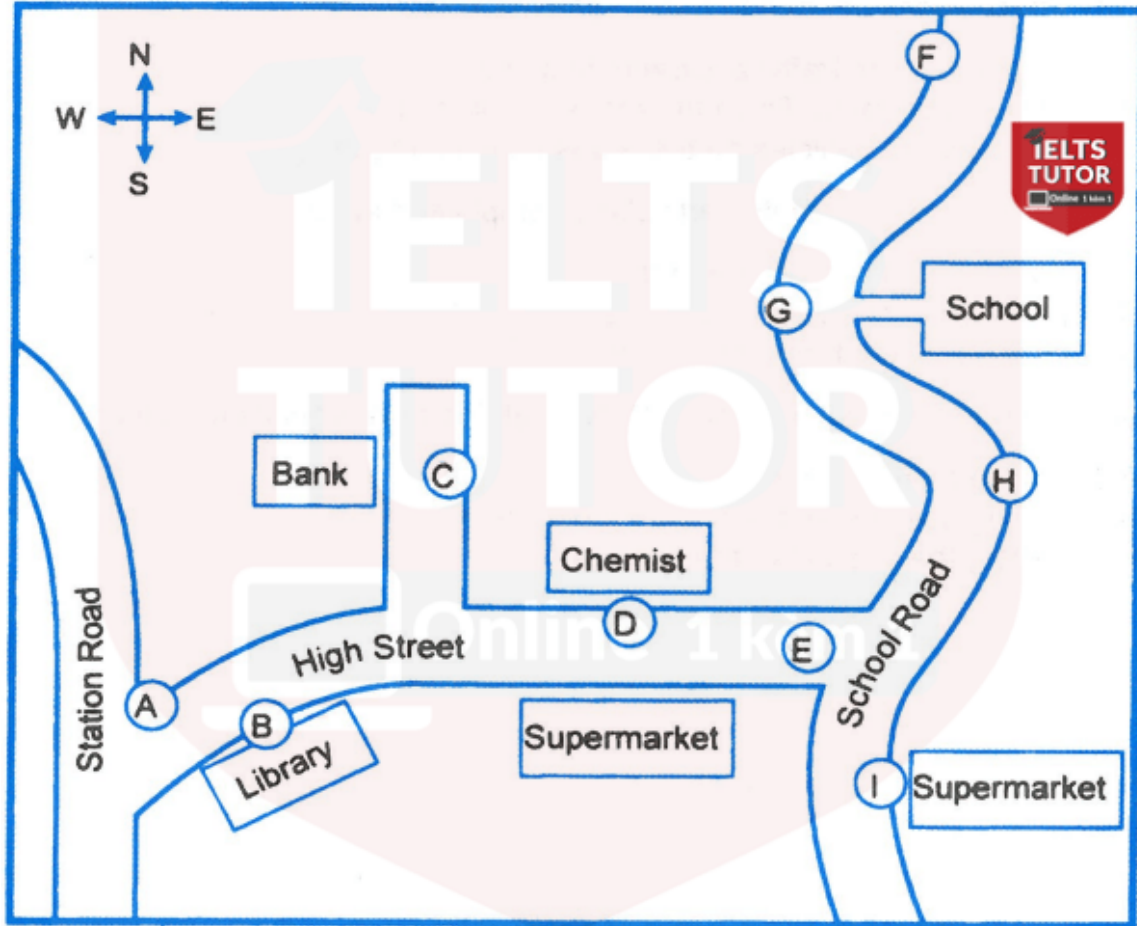

- 14. New traffic lights
- 15. Pedestrian crossing
- 16. Parking allowed
- 17. New 'No Parking' sign
- 18. New disabled parking spaces
- 19. Widened pavement
- 20. Lorry loading/unloading **restrictions**

50. Bài 50

Questions 11 – 16: Choose the correct letter, A, B or C.

Information on company volunteering projects

11. How much time for volunteering does the **company** allow per employee?
- A. two hours per week
 - B. one day per month
 - C. 8 hours per year
12. In feedback almost all employees said that volunteering improved their
- A. chances of promotion.
 - B. job satisfaction.
 - C. relationships with colleagues.
13. Last year some staff helped unemployed people with their
- A. literacy skills.
 - B. job applications.
 - C. communication skills.
14. This year the company will start a new volunteering project with a local
- A. school.
 - B. park.
 - C. charity.
15. Where will the Digital Inclusion Day be held?
- A. at the company's training facility
 - B. at a college
 - C. in a community centre
16. What should staff do if they want to take part in the Digital Inclusion Day?
- A. fill in a form
 - B. attend a training workshop
 - C. get permission from their manager

Questions 17 and 18

Choose *TWO* letters, A-E.

What *TWO* things are mentioned about the participants on the last Digital Inclusion Day?

- A. They were all over 70.
- B. They never used their computer.
- C. Their phones were mostly old-fashioned.
- D. They only used their phones for making calls.
- E. They initially showed little interest.

Questions 19 and 20

Choose *TWO* letters, A-E.

What *TWO* activities on the last Digital Inclusion Day did participants describe as useful?

- A. learning to use tables
- B. communicating with **family**
- C. shopping online
- D. playing online games
- E. sending emails

51. Bài 51

Questions 11 – 16

Choose SIX answers from the box and write the correct letter, A-G, next to Questions 11-16.

What advantage does the speaker mention for each of the following physical activities?

Advantages

- A. not dependent on season
- B. enjoyable
- C. low risk of injury
- D. fitness level unimportant
- E. sociable
- F. fast results
- G. motivating

Physical activities

- 11. using a gym
- 12. running
- 13. swimming
- 14. cycling
- 15. doing yoga
- 16. training with a personal trainer

Questions 17 and 18

Choose *TWO* letters, A-E.

For which *TWO* reasons does the speaker say people give up going to the gym?

- A. lack of time
- B. loss of confidence
- C. too much effort required
- D. high costs
- E. feeling less successful than others

Questions 19 and 20

Choose *TWO* letters, A-E.

Which *TWO* pieces of advice does the speaker give for setting goals?

- A. write goals down
- B. have achievable aims
- C. set a time **limit**
- D. give yourself rewards
- E. challenge yourself

52. Bài 52

Questions 11 – 16: Choose the correct letter, A, B or C.

The Snow Centre

11. Annie **recommends** that when cross-country skiing, the visitors should
- A. get away from the regular trails.
 - B. stop to enjoy views of the scenery.
 - C. go at a slow speed at the beginning.
12. What does Annie tell the group about this afternoon's dog-sled trip?
- A. Those who want to can take part in a race.
 - B. Anyone has the chance to drive a team of dogs.
 - C. One group member will be chosen to lead the trail.
13. What does Annie say about the team relay event?
- A. All participants receive a medal.
 - B. The course is 4 km long.
 - C. Each team is led by a teacher.
14. On the snow-shoe trip, the visitors will
- A. visit an old gold mine.
 - B. learn about unusual flowers.
 - C. climb to the top of a mountain.
15. The cost of accommodation in the mountain hut includes
- A. a supply of drinking water.
 - B. transport of visitors' luggage.
 - C. cooked meals.
16. If there is a storm while the visitors are in the hut, they should
- A. contact the bus driver.
 - B. wait until the weather improves.
 - C. use the emergency locator beacon.

Questions 17 – 20

Choose *FOUR* answers from the box and write the correct letter, A-F, next to Questions 17-20.

What information does Annie give about skiing on each of the following mountain trails?

Information

- A. It has a good place to stop and rest.
- B. It is suitable for all abilities.
- C. It involves crossing a river.
- D. It demands a lot of skill.
- E. It may be closed in bad **weather**.
- F. It has some very narrow sections.

Mountain trails

- 17. Highland Trail
- 18. Pine Trail
- 19. Stony Trail
- 20. Loser's Trail

53. Bài 53

Questions 11 and 12

Choose TWO letters, A-E.

Which TWO pieces of advice for the first week of an apprenticeship does the manager give?

- A. get to know colleagues
- B. learn from any mistakes
- C. ask lots of questions
- D. react positively to feedback
- E. enjoy new challenges

Questions 13 and 14

Choose TWO letters, A-E.

Which TWO things does the manager say mentors can help with?

- A. confidence-building
- B. making career plans
- C. completing difficult tasks
- D. making a weekly timetable
- E. reviewing progress

Questions 15-20

Write the correct letter, A, B or C, next to Questions 15-20.

What does the manager say about each of the following aspects of the company policy for apprentices?

- A. It is encouraged.
- B. There are some restrictions.
- C. It is against the rules.

Company policy for apprentices

- 15. Using the internet
- 16. Flexible working
- 17. Booking holidays
- 18. Working **overtime**
- 19. Wearing trainers
- 20. Bringing food to work